



Highfield Road, Liverpool,
Merseyside, L36

£950 per month

 **Reeds Rains**

[reedsrains.co.uk](https://www.reedsrains.co.uk)

Highfield Road, Liverpool, Merseyside, L36
£950 per month

Reeds Rains are delighted to offer for let this beautifully presented three bedroom detached property occupying a corner position. The accommodation comprises of entrance hall, downstairs WC, living room and dining kitchen with patio doors to the rear garden. First floor consists of three bedroom with master having an en-suite and also a family bathroom. The property has lawned gardens to the front, side and rear along with a driveway and detached garage.

EPC Grade C. Council Tax Band C...

GROUND FLOOR

Entrance Hall

WC

Window to side aspect. Radiator. Grey laminate flooring. Low level WC and hand wash basin.

Living Room

4.40 x 3.56
Window to front aspect. Radiator. Wood effect laminate flooring. Feature fire and surround.

Kitchen

4.65 x 3.17
Window and patio doors to rear aspect. Radiator. Grey laminate flooring. A range of white gloss wall and base units with oven/hob, washing machine, fridge, freezer and dishwasher. Under stairs storage cupboard.

FIRST FLOOR

Landing

Bedroom One

4.56 x 3.77
Windows to rear and side aspect. Radiator. Carpeted flooring. Storage cupboard. Access to en-suite bathroom.

En-Suite

2.55 x 1.39

Window to side aspect. Radiator. Wood effect laminate flooring. Shower cubicle, low level WC and hand wash basin.

Bedroom Two

3.91 x 3.46
Windows to front and side aspect. Radiator. Carpeted flooring.

Bedroom Three

2.82 x 2.37
Window to front aspect. Radiator. Carpeted flooring.

Bathroom

2.26 x 1.48
Window to rear aspect. Radiator. Wood effect laminate flooring. White three piece suite comprising panel bath with shower over, low level WC and hand wash basin.

EXTERNAL

Driveway and detached garage. Garden to rear.

Front

Lawn to the front and side.

Rear

Paved area leading on to lawn. Detached Garage and driveway.

Reeds Rains Limited Registered in England at Howard House, 3 St Mary's Court, Blossom Street, York, YO24 1AH
Registered Number 2568254. VAT Reg No. 842 795 983.

All Measurements
All Measurements are Approximate.

Laser Tape Clause
All measurements have been taken using a laser tape measure and therefore, may be subject to a small margin of error.

Floorplan Clause
Measurements are approximate. Not to Scale. For illustrative purposes only.

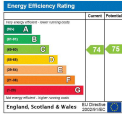

For full EPC please contact the branch.

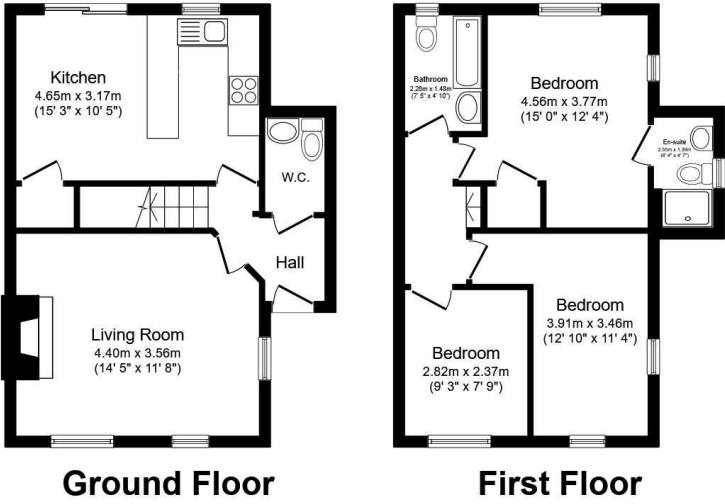

Total floor area 82.0 sq. m. (883 sq. ft.) approx
This plan is for illustration purposes only and may not be representative of the property.
Plan not to scale.

Powered by audioagent.com

We may refer you to recommended providers of ancillary services such as Conveyancing, Mortgages, Insurance and Surveying. We may receive a referral fee for recommending their services. You are not under any obligation to use the services of the recommended provider, which may also be an associated company of Reeds Rains.