

Windsor Road, Garstang, Preston

Asking Price: £135,000
Leasehold

 **Reeds Rains**

[reedsrains.co.uk](https://www.reedsrains.co.uk)

Windsor Road, Garstang, Preston
Asking Price: £135,000 Leasehold

OFFERED WITH NO ONWARD CHAIN
This apartment is perfectly placed right in the very heart of Garstang with several amenities all placed within easy walking distance. The property would suit a wide variety of purchasers including both residential and BTL investors. The A6 by pass road is only a short drive away allowing easy commutes to Preston, Lancaster and other major motorway networks to help you travel across the region. The Lake District is just a little further North and can be...

First Floor

Entrance Hall

Two storage cupboards. Central heating radiator.

Lounge/Dining Room

20'9" x 11'2" (6.32m x 3.4m)
Two central heating radiator. Double glazed windows to front and side aspects.

Kitchen

9'3" x 8'6" (2.82m x 2.6m)
Fitted with a range of wall, base and drawer units with complimentary work surfaces. Integrated oven, hob and extractor fan over. Space for various white goods. Sink with mixer tap over. Tiled splash backs. UPVC double glazed window to rear aspect.

Utility Room

Shelved storage. Space for tumble dryer.

Bedroom One

12'2" x 8'6" (3.7m x 2.6m)
Central heating radiator. UPVC double glazed window to front aspect.

Bedroom Two

8'6" x 7'5" (2.6m x 2.26m)
Central heating radiator. UPVC double glazed window to front aspect.

Bathroom

Low-level Wc. Hand basin. Panelled bath. Shower. Tiled flooring. Part tiled elevations. UPVC double glazed window to rear aspect.

External

The rear of the property provides laid to lawn communal gardens.

EPC

Grade D.

Tenure

Leasehold.

Reeds Rains Limited Registered in England at 2nd Floor, Gateway 2, Holgate Park Drive, York, YO26 4GB
Registered Number 2568254. VAT Reg No. 842 795 983.

All Measurements
All Measurements are Approximate.

Laser Tape Clause
All measurements have been taken using a laser tape measure and therefore, may be subject to a small margin of error.

Floorplan Clause
Measurements are approximate. Not to Scale. For illustrative purposes only.

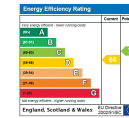

For full EPC please contact the branch.

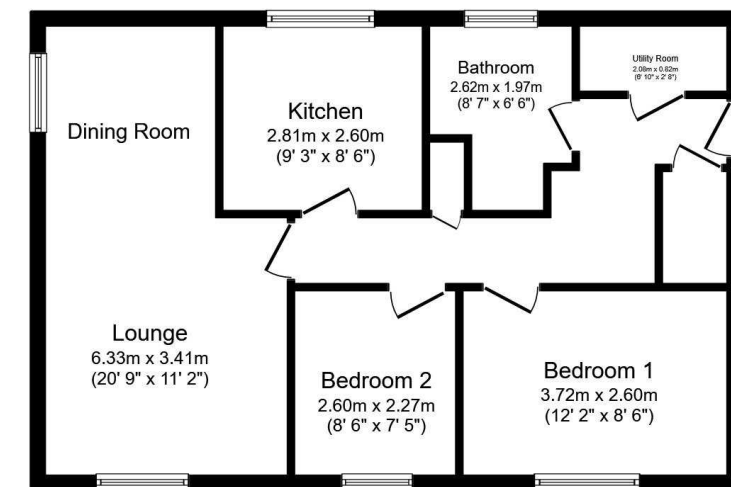

Floor Plan

Total floor area 61.0 sq. m. (657 sq. ft.) approx
This plan is for illustration purposes only and may not be representative of the property.
Plan not to scale.

Powered by audioagent.com

We may refer you to recommended providers of ancillary services such as Conveyancing, Mortgages, Insurance and Surveying. We may receive a referral fee for recommending their services. You are not under any obligation to use the services of the recommended provider, which may also be an associated company of Reeds Rains.