

Bridgefield Court, Bridge Road,  
Prescot, Merseyside

**£650 per month Part  
Furnished**

 **Reeds Rains**

[reedsrains.co.uk](https://reedsrains.co.uk)



Bridgefield Court, Bridge Road, Prescot, Merseyside  
£650 per month Part Furnished

\*\*\*AVAILABLE NOW, CALL TO ARRANGE A VIEWING\*\*\*

This modern second floor apartment is a stone's throw away from the town's local amenities and even offers its own parking. It is ideally located for schools, public transport routes and motorway links. The apartment briefly comprises of entrance hall, two bedrooms and bathroom. The open plan kitchen/dining and kitchen area includes appliances and benefits from a balcony. EPC Grade C.

Entrance Hall

Carpeted flooring. Intercom system. Built in storage cupboard.

Bathroom

2.90 x 1.90  
Vinyl flooring and tiled walls. Heated towel rail. White three piece suite comprising panel bath, low level WC and hand wash basin. Sperate shower cubicle also included.

Bedroom 1

4.00 x 2.90  
Window to front aspect. Door giving access to bathroom. Electric heater. Carpeted flooring. Furniture included-bed and wardrobe.

Bedroom 2

2.80 x 2.78  
Window to front aspect. Electric heater. Carpeted flooring. Furniture included - bed, wardrobe and bookcase.

Kitchen/Living/Dining Room

6.30 x 4.70  
UPVC door leading to balcony. Window to side aspect. Electric heater. Carpeted flooring. Furniture included - Sofa, recliner chair, two small tables, lamp, dining table and four chairs.

Wood effect vinyl flooring. Range of wall and base units with integrated oven/hob and extractor hood. Appliances included are

fridge/freezer and washer/dryer.

EXTERNAL

Balcony with table and two chairs. Communal parking.

Reeds Rains Limited Registered in England at 2nd Floor, Gateway 2, Holgate Park Drive, York, YO26 4GB  
Registered Number 2568254. VAT Reg No. 842 795 983.

All Measurements  
All Measurements are Approximate.

Laser Tape Clause  
All measurements have been taken using a laser tape measure and therefore, may be subject to a small margin of error.

Floorplan Clause  
Measurements are approximate. Not to Scale. For illustrative purposes only.

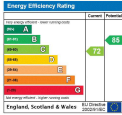

For full EPC please contact the branch.

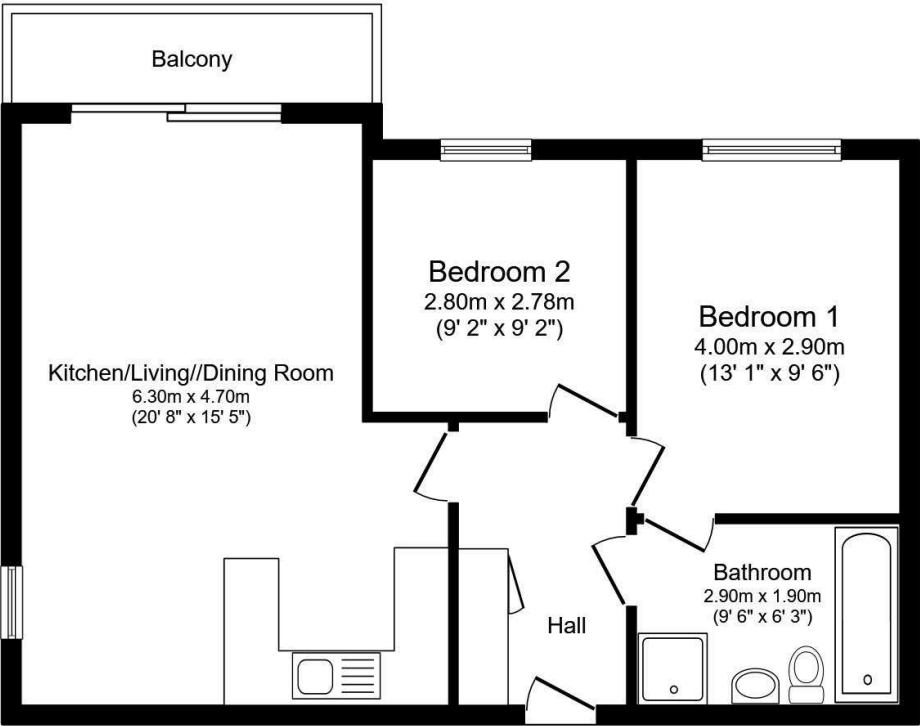

This floor plan is for illustrative purposes only. It is not drawn to scale. Any measurements, floor areas (including any total floor area), openings and orientation are approximate. No details are guaranteed, they cannot be relied upon for any purpose and they do not form part of any agreement. No liability is taken for any error, omission or misstatement. A party must rely upon its own inspection(s). Plan produced for Reed Rains. Powered by [www.focalagent.com](http://www.focalagent.com)

We may refer you to recommended providers of ancillary services such as Conveyancing, Mortgages, Insurance and Surveying. We may receive a referral fee for recommending their services. You are not under any obligation to use the services of the recommended provider, which may also be an associated company of Reeds Rains.