

Silkhouse Court, Tithebarn Street,
Liverpool, Merseyside

£1,000 per month

 **Reeds Rains**

[reedsrains.co.uk](https://www.reedsrains.co.uk)

Silkhouse Court, Tithebarn Street, Liverpool, Merseyside
£1,000 per month

Reeds Rains Limited Registered in England at 2nd Floor, Gateway 2,
Holgate Park Drive, York, YO26 4GB
Registered Number 2568254. VAT Reg No. 842 795 983.

All Measurements
All Measurements are Approximate.

Laser Tape Clause
All measurements have been taken using a laser tape measure and
therefore, may be subject to a small margin of error.

Floorplan Clause
Measurements are approximate. Not to Scale. For illustrative
purposes only.

For full EPC please contact the branch.

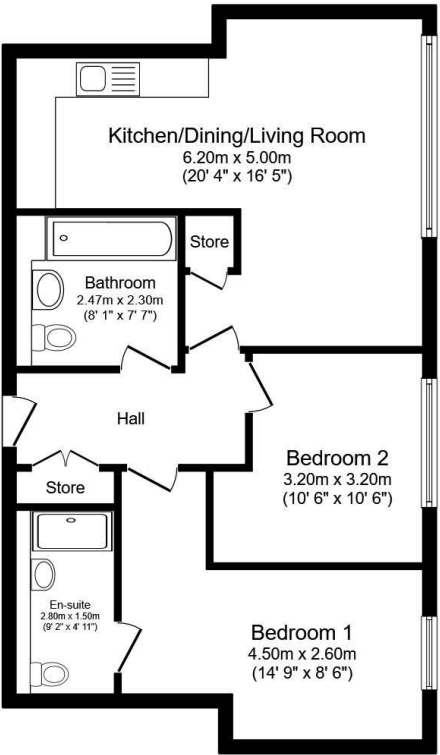

Total floor area 64.0 sq.m. (688 sq.ft.) approx
This floor plan is for illustrative purposes only. It is not drawn to scale. Any measurements, floor areas (including any total floor area), openings and orientation are approximate. No details are guaranteed, they cannot be relied upon for any purpose and they do not form part of any agreement. No liability is taken for any error, omission or misstatement. A party must rely upon its own inspection(s). Plan produced for Reed Rains. Powered by www.focalagent.com

We may refer you to recommended providers of ancillary services such as Conveyancing, Mortgages, Insurance and Surveying. We may receive a referral fee for recommending their services. You are not under any obligation to use the services of the recommended provider, which may also be an associated company of Reeds Rains.